

# C-LINE

# TITAN

PI 245HC B - PI 235HC B

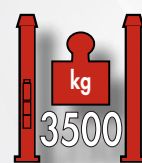
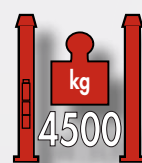

**Electro-hydraulic two post lifts with base connection**  
for low ceiling height



Electro-hydraulic two post lifts with base connection for low ceiling height.

**Realignment of the two carriages** using metal cables that guarantee **excellent synchronisation**.

Three-stages asymmetrical lifting arms.

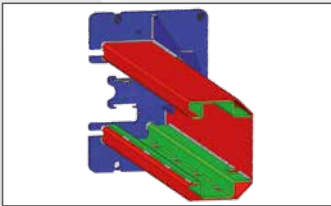

**Internally reinforced column structure** for little bending and internal cable guiding.



**Double threaded lifting pad** to ensure excellent vertical adjustment (95÷180 mm).

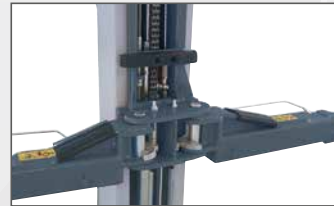

Rubber door protections.  
**Toothed sector arm rotation stop system**



**Four three-section asymmetrical arms.** Last section of arms very thin (30mm), for easy access to flat vehicles.

### Technical data

TITAN	PI 245HC B	PI 235HC B
Lift capacity	<b>4500 kg</b>	<b>3500 kg</b>
Lifting time	<b>40 s</b>	<b>40 s</b>
Motor	<b>400/230V-3kW-3ph-50 Hz</b>	<b>400/230V-3kW-3ph-50 Hz</b>
Lift max. lifting height	<b>2003 mm</b>	<b>2003 mm</b>
Lift minimum height	<b>100 mm</b>	<b>100 mm</b>

### Supplied accessories

- Mechanical carriage support device on each column ensures optimum working safety.
- Two set of extension pads.

### Optional



- A - 8-43300021** Set of 4 extension for pads, H=35 mm
- B - 8-43300014** Set of 4 extension for pads, H=80 mm
- C - 8-43300015** Set of 4 extension for pads, H=140 mm
- D - 8-43300016** Set of 4 adapters for Mercedes Sprinter

### Dimensions

